

The ORIGINAL
EDGE RIGHT[®]
Bullnosing Bench



mailing:

Tile Essentials, Inc.
P.O. Box 2520
Portland, OR 97208

fax:

503-345-9628

on the web:

www.tileessentials.com

phone:

503-236-8748

toll free:

877-238-8748

Congratulations!

You've just purchased the **EdgeRight® bullnosing bench**. Proudly made in the USA, this heavy-duty precision tool will save you time and money, giving you the EDGE on your competition. Our goal is to make a great craftsman like you, even better!



WARNINGS – SAFETY FIRST!

Our concern is for your personal safety. To reduce risk of injury, user must read and understand operating and assembly instructions.

- ⊙ *Make sure all knobs and bolts are securely tightened before use.*
- ⊙ *Use only on a flat, hard surface. If placed on an incline, the bench may fall over.*
- ⊙ *Use caution when lifting and transporting the **EdgeRight® bullnosing bench**.*
- ⊙ *Always tie down the **EdgeRight® bullnosing bench** when transporting.*
- ⊙ *Always give a copy of this manual to the equipment user.*
- ⊙ *Do not operate the **EdgeRight® bullnosing bench** unless you have read and understood this operator's manual.*
- ⊙ *Do not operate the **EdgeRight® bullnosing bench** if you are uncertain of how to operate the tool.*
- ⊙ *Do not stand on the **EdgeRight® bullnosing bench** or use it as a sawhorse.*
- ⊙ *Do not use the **EdgeRight® bullnosing bench** for other than its intended use.*
- ⊙ *Do not overload the **EdgeRight® bullnosing bench** – maximum capacity 200 lbs.*

Assembly Instructions

Please read the following Assembly and Operating Instructions carefully. Refer to the *assembly diagram* for additional information on part numbers to assist you in assembling the unit. Care has been taken to include all-necessary parts, however, if you find that a part has not been included, please contact your distributor. A replacement part will usually be shipped within 24 hours.

No tools are required for assembly.

Step 1

Turn the pre-assembled bench portion (A) upside down, with label facing down, on a flat surface. Be sure the surface is free of debris.

Step 2

Insert the two legs (10) into the slots on one end plate and secure with three arm knobs (12).

Step 3

Insert the remaining two legs (10) into the slots on the opposite end plate and secure with three arm knobs (12).

Step 4

Set the *EdgeRight® bullnosing bench* in the operating position by holding the center of the assembled unit and turning it upright onto its legs.

It's that easy!

Assembly Diagram

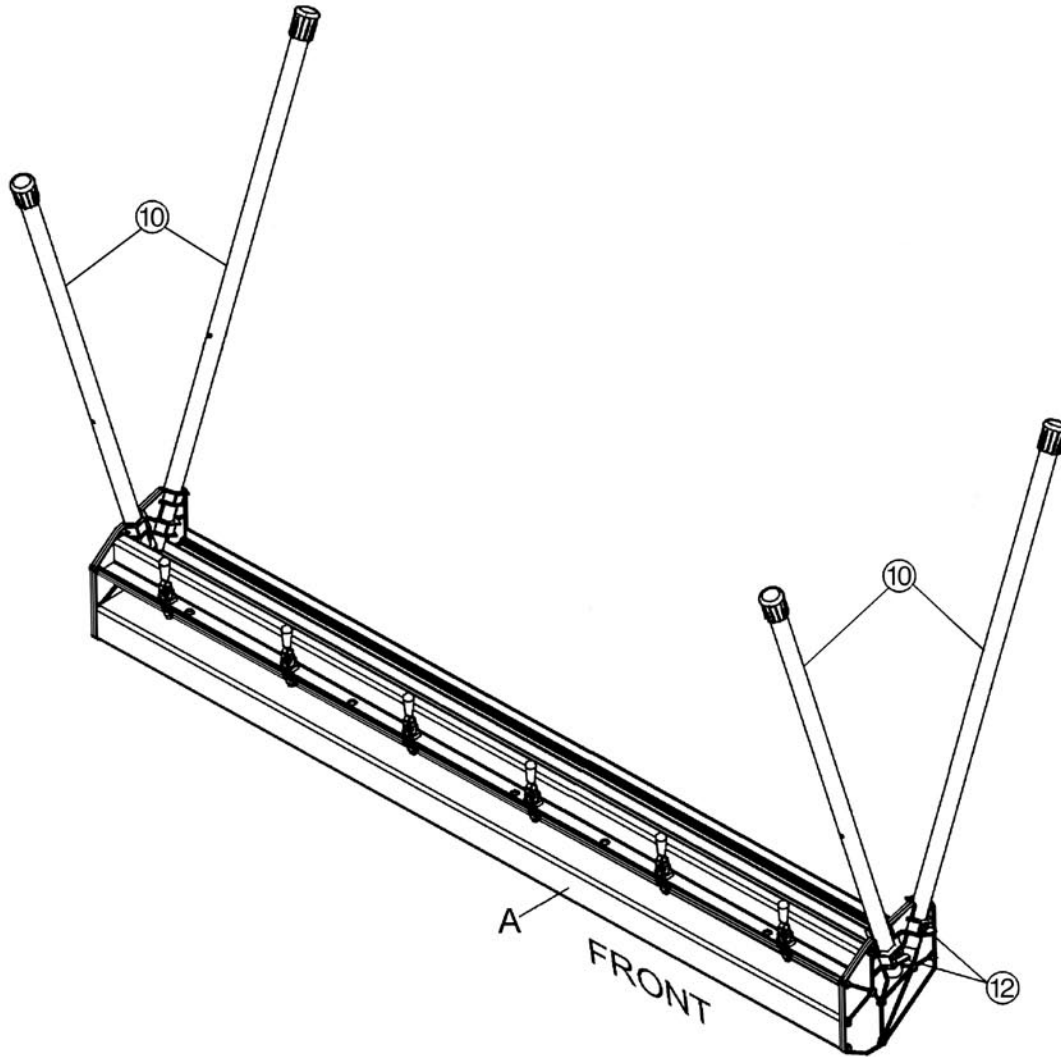

Operating Instructions

Please refer to the **Parts Diagram** for additional information on part numbers to assist you in operating the bench.

Step 1

The **EdgeRight® bullnosing bench** should be positioned on a hard, level surface.

Step 2

Make sure the legs are securely fastened by tightening the three arm knobs (12).

Step 3

Place individual tiles on the **EdgeRight®** platform from **left to right**. For precision polishing, place the *first* tile approximately 1/16" from *left* end plate (1) and press firmly against back guide (5). Each additional tile should be placed firmly against the back panel and firmly against the previous tile with no space in between tiles.



NOTE: *The unit is pre-assembled to accommodate 12" x 12" tiles. When polishing larger size tiles (16" or 18") insert and adjust clamps into clamp extrusion guide (see diagram) according to size of tiles being polished. Each clamp should be placed so it is securing tile near the center of the tile.*

Step 4

Insert and clamp each individual tile with red-handled clamps. Run fingers along top of tiles to make sure all tiles are level. If tiles are not level and secure, release clamp (7) and adjust clamp spindle (8) up or down ¼ turn to push tile against top to level.

Step 5

Once fabrication is complete, release tiles with red-handled clamps and remove tile.



Be careful not to pinch fingers between top of tile and top of extrusion.

Maintenance, Care and Cleaning

Maintenance: For optimum performance, clean and lubricate clamps after each use with a standard lubricating grease.

Care and Cleaning: Protect your investment by purchasing the water-resistant EdgeRight® carry bag, designed to easily transport the entire unit. Features a convenient pocket to keep assembly parts together. Part # CB600

Warranty

Limited one (1) year warranty against manufacturer's defects based on "normal" use. Use only as directed – if used for anything other than its intended use, warranty is null and void and all manufacturer's liability ceases.

Parts Diagram

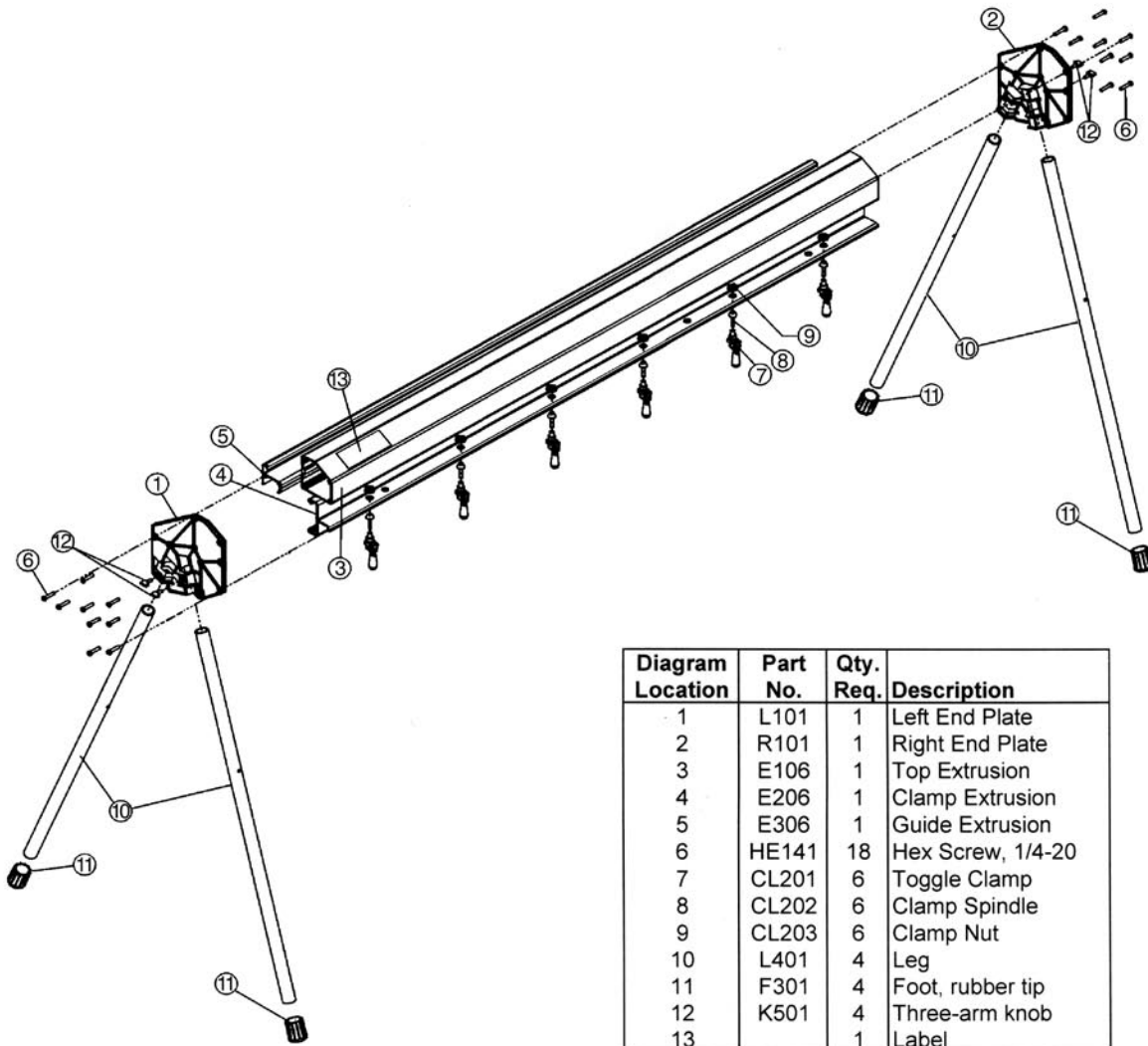

Diagram Location	Part No.	Qty. Req.	Description
1	L101	1	Left End Plate
2	R101	1	Right End Plate
3	E106	1	Top Extrusion
4	E206	1	Clamp Extrusion
5	E306	1	Guide Extrusion
6	HE141	18	Hex Screw, 1/4-20
7	CL201	6	Toggle Clamp
8	CL202	6	Clamp Spindle
9	CL203	6	Clamp Nut
10	L401	4	Leg
11	F301	4	Foot, rubber tip
12	K501	4	Three-arm knob
13		1	Label

